

CONSULTATION DRAFT ANNUAL PLAN 2020/2021



Rubbish and Recycling Services



Clarence Valley Access - Glen Alton Bridge



Kaikōura Aquatic Centre Loan



provide
suitable
infrastructure.



improve
quality of
life.



meet the
needs of our
community.



improve
the local
economy.



value the
environment +
biodiversity.



have
community
participation.



Polar Plunge 2019

CONTENTS

Have Your Say	3
Community Satisfaction 2019/2020	3
Message from the Mayor	4
Draft Annual Plan 2020/2021	5

TOPICS FOR CONVERSATION

Rubbish and Recycling Services	7
Waiau Toa/Clarence River - Glen Alton Bridge.....	10
Kaikōura Aquatic Centre Loan.....	12

KEY PROJECTS

Rates	14
Wakatu Quay/South Bay Business Case Update	16
Rebuild Update	17
Natural Hazards/District Plan	17
Have Your Say	18
Submission Form/Additional Feedback	19

Shared Intentions - Rebuilding Kaikōura Together

*Nāu te poha, nāku Te poha, ka ora ai te iwi
Through collaboration we will thrive*

*He hapori kotahi,
He waha kotahi,
Mo tatou katoa,
Mo ake tonu atu*

*We are one community,
We are one voice,
For the betterment of all of us,
For ever and ever*

HAVE YOUR SAY ON THE DRAFT ANNUAL PLAN 2020/2021

COME AND TALK TO US

We have a number of community consultations happening in the district. We'd love to see you and hear your views.

TARGET COMMUNITIES	DATE	TIME	LOCATION
Clarence / Kēkerengū	Thursday 9th July	5pm - 7pm	Kēkerengū Store
Inland Road / Oaro / Goose Bay	Tuesday 14th July	6pm - 8pm	Council Chambers
Everyone	Wednesday 22nd July	5pm - 7pm	Memorial Hall
Te Rūnanga o Kaikōura	Monday 27th July	5pm - 7pm	Takahanga Marae

WHERE DO I FIND OUT MORE?

- Attend a community discussion (see table above) and/or
- read the full draft Annual Plan via www.kaikoura.govt.nz or pick up a copy from the Library or Council offices.
- keep an eye out for information in the Kaikōura Star, our Facebook page, through the website, local community noticeboards and on the radio

HOW DO I HAVE MY SAY?

Go online at www.kaikoura.govt.nz or fill out a paper form and send it to us/drop it off. You can ask to speak at the Council hearings on the draft Annual Plan submissions. More information inside the back page of this document.

CULTURAL STATEMENT

Te Rūnanga o Kaikōura (TROK) supports opportunities for you to be involved in the draft Annual Plan consultations and to this end TROK will host a public meeting at the Takahanga Marae on July 27 between 5pm and 7pm.

COMMUNITY SATISFACTION 2019/2020

Each year the Kaikōura District Council uses a survey of residents and community members to gather feedback about Council-provided services and facilities. The survey was sent to as many property owners and tenants as possible, it was also promoted through Facebook and radio. The surveys were completed through a mix of phone interviews, online surveys and paper surveys.

This research measures Kaikōura resident satisfaction levels with Council service delivery performance, the region's sustainability, post-earthquake re-build and Civil Defence. The results show where we need to focus our resources on identified areas of concern.

Overall, Kaikōura residents and property owners were satisfied with life in their district: feeling safe, having their essential needs met, and engaging with their local environment. People have been increasingly positive about the post-earthquake infrastructure re-build programme and insurance claim resolution, and business confidence remains optimistic. 53% of community members were satisfied with Council's performance in 2019-2020.

This result was on par with previous years, with a slight trend for improvement.

Key areas for improvement related to enhancing the District as a place to live in and move around:

- Local development initiatives (economic and community)
- Infrastructure (roads and footpaths, including increased accessibility)
- While residents were satisfied with customer service contact and general council communications/updates, they sought improvements to more personal or specific touchpoints (responding to direct requests, and enhanced issue-related consultation).

"Public Library (and staff) - fantastic!!"
– Community satisfaction survey feedback 2019



MESSAGE FROM THE MAYOR

NEW COUNCIL ELECTED 2019

The new Council was sworn in on 30th October 2019. It's been quite the ride so far with COVID-19 but I am committed to and passionate about our town. As an elected Councillor representing the community for the past 7 years, I am working with a good team to ensure Council make the right decisions and lead the District forward.

We are facing unprecedented challenges for our small rating base - finishing the infrastructure rebuild as close to budget as feasible, finding a way forward for our rubbish and recycling and now working together on the economic recovery for COVID-19.

PARTNERSHIP WITH TE RŪNANGA O KAIKŌURA

One of the highlights of my role as Mayor has been connecting with Te Rūnanga o Kaikōura as our Treaty Partners. It is essential to have good understanding of each other and work with each other's strengths. We're already working together on a number of projects, it's the only way forward and a key part of our future as a community.

COVID – 19 RECOVERY

While we have some great projects in the pipeline, the next period is going to be tough for many people. The Kaikōura Economic Recovery Governance Group has been set up to bring community sectors together. The mission is to work together, looking at needs and solutions of our community, exploring job creation opportunities and leading the economic recovery of Kaikōura. Te Rūnanga O Kaikōura, Deputy Chair Rawiri Manawatu is leading the group with Council and other community leaders.

LONG TERM PLAN

There is no doubt things are going to be tough, with many businesses struggling after COVID-19 lockdown restrictions and the impact on tourism, but we can take the strange opportunity presented by COVID-19 to build on our strengths, creating the place we want Kaikōura to be, for us and our visitors. At the end of this year we'll start looking at the Long Term Plan for 2021 – 2031. It's really important that we work together to create this vision. The first step will be coming along to a community consultation for the draft Annual Plan.

DRAFT ANNUAL PLAN 2020/2021

Welcome to the Kaikōura District Council's draft Annual Plan 2020/2021, the third year of our Three Year Plan.

PARTNERSHIP WITH TE RŪNANGA O KAIKŌURA

We continue to build and strengthen our relationship with Te Rūnanga O Kaikōura as key Treaty Partners. This relationship is paramount to us moving forward and there is and will be participation on all key council projects and decisions.

UNPRECEDENTED AND UNCERTAIN TIMES

We recognised that the 10% rates increase signalled in the Three Year Plan (10%) would not be acceptable in the post COVID-19 environment. To this end Council revised the 2020/21 Annual Plan budget to mitigate the effects on ratepayers due to the impact of COVID-19 on the community, and the local economy.

From publicly available information most Councils in New Zealand are preparing to implement lesser increases than planned, with almost all suggesting increases less than 5%. We are pleased to confirm that our rates increase this year is proposed to be 4.6% and we are not creating an unacceptable burden for the following years.

I am further pleased to announce that we have introduced a rates relief package to ease the way for Kaikōura ratepayers hard-hit as a result of the COVID-19 crisis, and the package has been approved by Kaikōura District Council. More information is available on our website <https://www.kaikoura.govt.nz/our-services/rates/>

KAIKŌURA DISTRICT ECONOMIC DEVELOPMENT GOVERNANCE GROUP RECOVERY PLAN

At a meeting on 5 May 2020, Council resolved to form the Kaikōura District Economic Development Governance Group, chaired by Rawiri Manawatu. The group will provide an inclusive, collaborative, and multi-pronged sector approach founded on the four well-beings to recovery and re-imagination of our District's future in response to COVID -19.

The Group will continue the well-constructed plans from the Re-imagine Kaikōura Recovery Plan developed in 2016, reprioritising needs and seek to develop a vision and a roadmap for this district.

A partnership approach with Te Rūnanga O Kaikōura, Council and this Group will ensure the recovery is inclusive, building and strengthening our unique competitive advantage - our incredible natural environment, our rich cultural heritage and history, and our special marine and environmental focus.

FINANCIAL STEWARDSHIP

As is evident with the 2020/2021 Draft Annual Plan Council has lowered rates to ensure they remain affordable for our community during the post COVID-19 pandemic. We have provided options for rates relief to assist ratepayers in hardship and taken measures to ensure that no future infrastructure issues or legacy issues have been created by doing this. Council has secured low borrowing costs from the Local Government Funding Agency (LGFA) to make sure that borrowing costs remain as low as possible in the longer term.

Council made a decision in May 2020 to no longer support the Earthcheck accreditation, funds have been repurposed to focus on new policy requirements and leverage other potential external opportunities. These include the recent Government Budget 2020 announcements for post COVID-19 environmental related initiatives.

Council management are also proposing action to reduce payroll costs.

MAJOR STRATEGIC PROJECTS

Lead the development of the Ten Year Long Term Plan 2021-2031. The Kaikōura Ten Year Long Term Plan which will focus on reviewing the Council community outcomes, strategic direction, objectives and projects for the next 10 years. It will involve the development of an integrated financial and infrastructure strategy for the District. This will also involve a review of all core statutory policies.

- Complete the District Plan Review for the Natural Hazards Chapter – page 17
- Complete the horizontal infrastructure rebuild within minimal cost overruns – page 17
- Progress the Provincial Growth Funded development of Wakatu Quay and the business case for the development of South Bay harbour. – page 16

MAJOR STRATEGIC PROJECTS CONTINUED...

Finalise the Financial and Corporate Sustainability Project. Complete service assessments and lead improvements in asset, records and information management. Council will also continue to engage with potential neighbours for any shared service opportunities. A fit for purpose computerised asset management system (ADAPT) was put in place in 2019/2020. A priority for 2020/2021 is to include, validate and analyse water related data within ADAPT. This work will build a clear picture of the likely long term needs of councils water assets.

TOPICS FOR CONSULTATION

COMPLETE A REVIEW OF RUBBISH AND RECYCLING SERVICES. PG 7

Council is consulting with the community on a variety of refuse and recycling options. Continuing operation of the existing form of refuse and recycling services in Kaikoura poses both practical and financial challenges. The range of materials that can be accepted for recycling has been reduced in response to loss of international markets for these products.

The refuse and recycling services that have been provided by KDC through Innovative Waste Kaikoura (IWK) have in recent years been supported financially by other revenue streams within IWK – some associated with the earthquake recovery - but these revenues have diminished, with a need for more funding to come from the community if current levels of service are to be maintained.

The consultation through this draft Annual Plan is just the start of a process to decide what solid waste services should be provided to the community. Council also needs to prepare and seek public feedback on a detailed 'Waste Management and Minimisation Plan' (WMMP) and this will happen later this year.

ADDRESS THE LOSS OF ALL-WEATHER ACCESS ACROSS THE WAIU TOA/CLARENCE RIVER. PG 10

This provides two options to address the loss of all-weather access across the Waiu Toa/Clarence River (when the Glen Alton Bridge was destroyed in the November 2016 earthquake). Various options have been considered and a full business case analysis was undertaken to assess the best way forward. Two options have been provided.

SUPPORT THE CONSTRUCTION OF THE NEW KAIKŌURA AQUATIC CENTRE. PG 12

A \$500,000 loan from the Rātā Foundation has been awarded to the Trust, however with the Council able to borrow at much lower costs through the Local Government Funding Agency (LGFA), the Council has offered to increase its grant to the Trust from \$1M to \$1.5M - replacing the Rātā loan with cheaper Council funding (which results in less cost to rate payers).

DELIVERY OF WATER SERVICES

During 2020/2021 there will be a review of the way in Councils water services are delivered. This will meet the goals of the financial and corporate sustainability review and satisfy the requirements of section 17A of the Local Government Act 2002

Continue work to improve drinking water quality, safety and security of the Kaikōura Urban Scheme. An ultraviolet light (UV) disinfection stage will be added in the 2020/21 year. Water is pumped to reservoirs on the hills above Churchill Street and the peninsula.

Suburban Water Scheme - the stream source connection and local treatment are to be made redundant and new reticulation mains will be installed to enable connection to the Urban scheme treatment plant. This upgrade will allow the scheme to meet the NZ Drinking Water Standards. A carry-over of \$104,000 is in the Draft Annual Plan 2020/2021 will enable the works to be undertaken early in the 2020/21 financial year.

OTHER CAPITAL PROJECTS

A conversion of streetlights to LEDs is to take place progressively within the township, and the 2019/2020 budget of \$98k will rollover to 2020/2021 and increase to \$400k to make the most of the enhanced NZTA subsidy, which will cover 85% of the total upgrade cost. The upgrade will reduce future operating costs due to lower electricity costs.

COMMUNITY FACILITIES

In 2019/2020 major restoration of the Memorial Hall was undertaken, and the pensioner flats roofs were renewed. Now the management of these properties is largely returning to regular maintenance. The next target for renovation will be the Scout Hall, for which purpose Council has received Lotteries Commission funding of \$136,266 for use in the 2020/2021 year.

I would encourage you to provide feedback. The most important thing we can do is listen and hear, the voice of our community.

Kia kaha



Angela Oosthuizen – C.E.O





Recycling in Landfill

RUBBISH AND RECYCLING SERVICES

WHAT WE HAVE CURRENTLY

- One Landfill on Scarborough Street
- Weekly Kerbside Recycling collection in the urban area
- 4 Rural Recycling Drop off points
- Public Street Bins for refuse and recycling
- No council provided kerbside rubbish collection service

Innovative Waste Kaikōura (IWK) is contracted by Council and manages the above.

TOTAL COST OF REFUSE AND RECYCLING \$490,000

Landfill \$238,000
 Kerbside Recycling \$165,000
 Rural Recycling \$55,000
 Public Street Bins \$32,000

ISSUES, PLANS AND PROJECTS FOR 2020/2021

A comprehensive review is underway to make sure rubbish and recycling services in Kaikōura are designed, delivered and paid for in a way that is appropriate to the needs of the community, taking account of factors that include affordability, convenience and environmental protection.

The consultation through this draft Annual Plan is just the start of a process, Council also needs to prepare and seek public feedback on a detailed 'Waste Management and Minimisation Plan' (WMMP). This will happen later this year. Only when this is completed can final decisions on services be made.

We want to hear any ideas and solutions as well as feedback on the options presented.

AUGUST 2020	AUGUST/SEPTEMBER 2020	OCTOBER – DECEMBER 2020	JANUARY 2021
Community Consultation and Draft Annual Plan Feedback	Draft WMMP Community Consultation	Cost Delivery Options Investigated	Implementation

WHAT'S CHANGED?

- Dynamic economic environment with uncertainty post COVID-19
- Loss of international markets for recycling products
- Recycling products – some are limited value so uneconomic and go to landfill anyway
- Previously rubbish and recycling services have been supported financially by other revenue streams within Innovative Waste Kaikōura (IWK) – some associated with the earthquake recovery - but these revenues have diminished.

MORE THAN JUST COST

There are more important issues beyond simple 'in your pocket' costs to be considered. Since the 1990s, Kaikōura, like a number of other small NZ communities, strongly embraced the concept of 'zero waste'. Considerable energy and passion was invested in the pursuit of 'zero waste', with Innovative Waste Kaikōura (IWK) becoming the focus for associated activities.

Kaitiakitanga is a value that Ngāti Kurī practice by ensuring the whenua (land) is healthy and thriving. The importance of this practice ensures that the next generations have a home that is sustained by caring for the land through managing waste appropriately.

OPTION 1 - INCREASED COST

STATUS QUO RUBBISH AND KERBSIDE/RURAL COLLECTION RECYCLING SERVICES

OPTION 2 - INCREASED COST

RECYCLING ONLY AVAILABLE AT THE IWK RECOVERY CENTRE (NO COLLECTION SERVICE)

OPTION 3 - LOWER COST

LIMITED RECYCLING FOR PROFITABLE PRODUCTS

OPTION 4 - LOWER COST

LIMITED RECYCLING FOR PROFITABLE PRODUCTS AND SUBSIDISED COMPOSTING

Preferred
Option
OPTION 4

ESTIMATED OPTION COSTS (GST INCLUSIVE) – INDICATIVE ONLY

Currently KDC's solid waste services are funded through a combination of uniform annual rates and 'user pays' charges to IWK for refuse disposal and other services. Indicative average annual rates and 'user pays' fees for theoretically 'average' urban, rural and commercial properties in the current 2019/20 financial year are shown in the following table, together with corresponding 'best guess' estimates for the four options.

	Estimated Annual Rates Charge per Property			Estimated Average Total Annual 'User Pays' Charges per Property*			Estimated Average Combined Annual Charges per Property*		
	Urban	Rural	Commercial	Urban	Rural	Commercial	Urban	Rural	Commercial
Current Service (current non-sustainable charges)	\$208	\$160	\$242	\$250	\$130	\$600	\$458	\$290	\$842
Option 1 – Current Services (increased sustainable charges)	\$270	\$210	\$320	\$250	\$130	\$600	\$520	\$340	\$920
Option 2 – Limited Recycling	\$240	\$180	\$310	\$250	\$130	\$580	\$490	\$310	\$890
Option 3 – Lowest Cost	\$80	\$60	\$220	\$220	\$110	\$410	\$300	\$170	\$630
Option 4 – Limited Waste Diversion Subsidy	\$100	\$80	\$240	\$240	\$120	\$410	\$340	\$200	\$650

*These estimates are based on broad assumptions and there will be wide variations between individual properties, depending on how much waste each property produces.

More information on rubbish and recycling including frequently asked questions, how much the various options could save you and more than the \$ cost is available online: <https://www.kaikoura.govt.nz/our-council/plans-reports-bylaws-and-policies/>

	LITTER	RECYCLING	RE-USE	RECOVERY	DISPOSAL	
	Street Bins (litter only)	Plastics Glass Cardboard Metals	Re-Use Shop	Composting	Greenwaste Disposal Refuse Urban Kerbside Refuse	
	100% FUNDED BY RATES		MIX OF RATES & USER PAYS			MAINLY USER PAYS FUNDED
OPTION 1 <u>-Current Services</u>	<input checked="" type="checkbox"/>	<input checked="" type="checkbox"/>	<input checked="" type="checkbox"/>	<input checked="" type="checkbox"/>	<input checked="" type="checkbox"/>	<input checked="" type="checkbox"/>
OPTION 2 <u>-Limited Recycling</u>	<input checked="" type="checkbox"/>	<input checked="" type="checkbox"/>	<input checked="" type="checkbox"/>	<input checked="" type="checkbox"/>	<input checked="" type="checkbox"/>	<input checked="" type="checkbox"/>
OPTION 3 <u>-Lowest Cost</u>	<input checked="" type="checkbox"/>	<input checked="" type="checkbox"/>	<input checked="" type="checkbox"/>	<input checked="" type="checkbox"/>	<input checked="" type="checkbox"/>	<input checked="" type="checkbox"/>
OPTION 4 <u>-Limited Waste Diversion Subsidy</u>	<input checked="" type="checkbox"/>	<input checked="" type="checkbox"/>	<input checked="" type="checkbox"/>	<input checked="" type="checkbox"/>	<input checked="" type="checkbox"/>	<input checked="" type="checkbox"/>
	<input checked="" type="checkbox"/>	<input checked="" type="checkbox"/>	<input checked="" type="checkbox"/>	<input checked="" type="checkbox"/>	<input checked="" type="checkbox"/>	<input checked="" type="checkbox"/>
	<input checked="" type="checkbox"/>	<input checked="" type="checkbox"/>	<input checked="" type="checkbox"/>	<input checked="" type="checkbox"/>	<input checked="" type="checkbox"/>	<input checked="" type="checkbox"/>
	<input checked="" type="checkbox"/>	<input checked="" type="checkbox"/>	<input checked="" type="checkbox"/>	<input checked="" type="checkbox"/>	<input checked="" type="checkbox"/>	<input checked="" type="checkbox"/>
	<input checked="" type="checkbox"/>	<input checked="" type="checkbox"/>	<input checked="" type="checkbox"/>	<input checked="" type="checkbox"/>	<input checked="" type="checkbox"/>	<input checked="" type="checkbox"/>
	<input checked="" type="checkbox"/>	<input checked="" type="checkbox"/>	<input checked="" type="checkbox"/>	<input checked="" type="checkbox"/>	<input checked="" type="checkbox"/>	<input checked="" type="checkbox"/>
	<input checked="" type="checkbox"/>	<input checked="" type="checkbox"/>	<input checked="" type="checkbox"/>	<input checked="" type="checkbox"/>	<input checked="" type="checkbox"/>	<input checked="" type="checkbox"/>
	<input checked="" type="checkbox"/>	<input checked="" type="checkbox"/>	<input checked="" type="checkbox"/>	<input checked="" type="checkbox"/>	<input checked="" type="checkbox"/>	<input checked="" type="checkbox"/>
	<input checked="" type="checkbox"/>	<input checked="" type="checkbox"/>	<input checked="" type="checkbox"/>	<input checked="" type="checkbox"/>	<input checked="" type="checkbox"/>	<input checked="" type="checkbox"/>
	<input checked="" type="checkbox"/>	<input checked="" type="checkbox"/>	<input checked="" type="checkbox"/>	<input checked="" type="checkbox"/>	<input checked="" type="checkbox"/>	<input checked="" type="checkbox"/>
	<input checked="" type="checkbox"/>	<input checked="" type="checkbox"/>	<input checked="" type="checkbox"/>	<input checked="" type="checkbox"/>	<input checked="" type="checkbox"/>	<input checked="" type="checkbox"/>
	<input checked="" type="checkbox"/>	<input checked="" type="checkbox"/>	<input checked="" type="checkbox"/>	<input checked="" type="checkbox"/>	<input checked="" type="checkbox"/>	<input checked="" type="checkbox"/>
	<input checked="" type="checkbox"/>	<input checked="" type="checkbox"/>	<input checked="" type="checkbox"/>	<input checked="" type="checkbox"/>	<input checked="" type="checkbox"/>	<input checked="" type="checkbox"/>
	<input checked="" type="checkbox"/>	<input checked="" type="checkbox"/>	<input checked="" type="checkbox"/>	<input checked="" type="checkbox"/>	<input checked="" type="checkbox"/>	<input checked="" type="checkbox"/>
	<input checked="" type="checkbox"/>	<input checked="" type="checkbox"/>	<input checked="" type="checkbox"/>	<input checked="" type="checkbox"/>	<input checked="" type="checkbox"/>	<input checked="" type="checkbox"/>
	<input checked="" type="checkbox"/>	<input checked="" type="checkbox"/>	<input checked="" type="checkbox"/>	<input checked="" type="checkbox"/>	<input checked="" type="checkbox"/>	<input checked="" type="checkbox"/>
	<input checked="" type="checkbox"/>	<input checked="" type="checkbox"/>	<input checked="" type="checkbox"/>	<input checked="" type="checkbox"/>	<input checked="" type="checkbox"/>	<input checked="" type="checkbox"/>
	<input checked="" type="checkbox"/>	<input checked="" type="checkbox"/>	<input checked="" type="checkbox"/>	<input checked="" type="checkbox"/>	<input checked="" type="checkbox"/>	<input checked="" type="checkbox"/>
	<input checked="" type="checkbox"/>	<input checked="" type="checkbox"/>	<input checked="" type="checkbox"/>	<input checked="" type="checkbox"/>	<input checked="" type="checkbox"/>	<input checked="" type="checkbox"/>
	<input checked="" type="checkbox"/>	<input checked="" type="checkbox"/>	<input checked="" type="checkbox"/>	<input checked="" type="checkbox"/>	<input checked="" type="checkbox"/>	<input checked="" type="checkbox"/>
	<input checked="" type="checkbox"/>	<input checked="" type="checkbox"/>	<input checked="" type="checkbox"/>	<input checked="" type="checkbox"/>	<input checked="" type="checkbox"/>	<input checked="" type="checkbox"/>
	<input checked="" type="checkbox"/>	<input checked="" type="checkbox"/>	<input checked="" type="checkbox"/>	<input checked="" type="checkbox"/>	<input checked="" type="checkbox"/>	<input checked="" type="checkbox"/>
	<input checked="" type="checkbox"/>	<input checked="" type="checkbox"/>	<input checked="" type="checkbox"/>	<input checked="" type="checkbox"/>	<input checked="" type="checkbox"/>	<input checked="" type="checkbox"/>
	<input checked="" type="checkbox"/>	<input checked="" type="checkbox"/>	<input checked="" type="checkbox"/>	<input checked="" type="checkbox"/>	<input checked="" type="checkbox"/>	<input checked="" type="checkbox"/>
	<input checked="" type="checkbox"/>	<input checked="" type="checkbox"/>	<input checked="" type="checkbox"/>	<input checked="" type="checkbox"/>	<input checked="" type="checkbox"/>	<input checked="" type="checkbox"/>
	<input checked="" type="checkbox"/>	<input checked="" type="checkbox"/>	<input checked="" type="checkbox"/>	<input checked="" type="checkbox"/>	<input checked="" type="checkbox"/>	<input checked="" type="checkbox"/>
	<input checked="" type="checkbox"/>	<input checked="" type="checkbox"/>	<input checked="" type="checkbox"/>	<input checked="" type="checkbox"/>	<input checked="" type="checkbox"/>	<input checked="" type="checkbox"/>
	<input checked="" type="checkbox"/>	<input checked="" type="checkbox"/>	<input checked="" type="checkbox"/>	<input checked="" type="checkbox"/>	<input checked="" type="checkbox"/>	<input checked="" type="checkbox"/>
	<input checked="" type="checkbox"/>	<input checked="" type="checkbox"/>	<input checked="" type="checkbox"/>	<input checked="" type="checkbox"/>	<input checked="" type="checkbox"/>	<input checked="" type="checkbox"/>
	<input checked="" type="checkbox"/>	<input checked="" type="checkbox"/>	<input checked="" type="checkbox"/>	<input checked="" type="checkbox"/>	<input checked="" type="checkbox"/>	<input checked="" type="checkbox"/>
	<input checked="" type="checkbox"/>	<input checked="" type="checkbox"/>	<input checked="" type="checkbox"/>	<input checked="" type="checkbox"/>	<input checked="" type="checkbox"/>	<input checked="" type="checkbox"/>
	<input checked="" type="checkbox"/>	<input checked="" type="checkbox"/>	<input checked="" type="checkbox"/>	<input checked="" type="checkbox"/>	<input checked="" type="checkbox"/>	<input checked="" type="checkbox"/>
	<input checked="" type="checkbox"/>	<input checked="" type="checkbox"/>	<input checked="" type="checkbox"/>	<input checked="" type="checkbox"/>	<input checked="" type="checkbox"/>	<input checked="" type="checkbox"/>
	<input checked="" type="checkbox"/>	<input checked="" type="checkbox"/>	<input checked="" type="checkbox"/>	<input checked="" type="checkbox"/>	<input checked="" type="checkbox"/>	<input checked="" type="checkbox"/>
	<input checked="" type="checkbox"/>	<input checked="" type="checkbox"/>	<input checked="" type="checkbox"/>	<input checked="" type="checkbox"/>	<input checked="" type="checkbox"/>	<input checked="" type="checkbox"/>
	<input checked="" type="checkbox"/>	<input checked="" type="checkbox"/>	<input checked="" type="checkbox"/>	<input checked="" type="checkbox"/>	<input checked="" type="checkbox"/>	<input checked="" type="checkbox"/>
	<input checked="" type="checkbox"/>	<input checked="" type="checkbox"/>	<input checked="" type="checkbox"/>	<input checked="" type="checkbox"/>	<input checked="" type="checkbox"/>	<input checked="" type="checkbox"/>
	<input checked="" type="checkbox"/>	<input checked="" type="checkbox"/>	<input checked="" type="checkbox"/>	<input checked="" type="checkbox"/>	<input checked="" type="checkbox"/>	<input checked="" type="checkbox"/>
	<input checked="" type="checkbox"/>	<input checked="" type="checkbox"/>	<input checked="" type="checkbox"/>	<input checked="" type="checkbox"/>	<input checked="" type="checkbox"/>	<input checked="" type="checkbox"/>
	<input checked="" type="checkbox"/>	<input checked="" type="checkbox"/>	<input checked="" type="checkbox"/>	<input checked="" type="checkbox"/>	<input checked="" type="checkbox"/>	<input checked="" type="checkbox"/>
	<input checked="" type="checkbox"/>	<input checked="" type="checkbox"/>	<input checked="" type="checkbox"/>	<input checked="" type="checkbox"/>	<input checked="" type="checkbox"/>	<input checked="" type="checkbox"/>
	<input checked="" type="checkbox"/>	<input checked="" type="checkbox"/>	<input checked="" type="checkbox"/>	<input checked="" type="checkbox"/>	<input checked="" type="checkbox"/>	<input checked="" type="checkbox"/>
	<input checked="" type="checkbox"/>	<input checked="" type="checkbox"/>	<input checked="" type="checkbox"/>	<input checked="" type="checkbox"/>	<input checked="" type="checkbox"/>	<input checked="" type="checkbox"/>
	<input checked="" type="checkbox"/>	<input checked="" type="checkbox"/>	<input checked="" type="checkbox"/>	<input checked="" type="checkbox"/>	<input checked="" type="checkbox"/>	<input checked="" type="checkbox"/>
	<input checked="" type="checkbox"/>	<input checked="" type="checkbox"/>	<input checked="" type="checkbox"/>	<input checked="" type="checkbox"/>	<input checked="" type="checkbox"/>	<input checked="" type="checkbox"/>
	<input checked="" type="checkbox"/>	<input checked="" type="checkbox"/>	<input checked="" type="checkbox"/>	<input checked="" type="checkbox"/>	<input checked="" type="checkbox"/>	<input checked="" type="checkbox"/>
	<input checked="" type="checkbox"/>	<input checked="" type="checkbox"/>	<input checked="" type="checkbox"/>	<input checked="" type="checkbox"/>	<input checked="" type="checkbox"/>	<input checked="" type="checkbox"/>
	<input checked="" type="checkbox"/>	<input checked="" type="checkbox"/>	<input checked="" type="checkbox"/>	<input checked="" type="checkbox"/>	<input checked="" type="checkbox"/>	<input checked="" type="checkbox"/>
	<input checked="" type="checkbox"/>	<input checked="" type="checkbox"/>	<input checked="" type="checkbox"/>	<input checked="" type="checkbox"/>	<input checked="" type="checkbox"/>	<input checked="" type="checkbox"/>
	<input checked="" type="checkbox"/>	<input checked="" type="checkbox"/>	<input checked="" type="checkbox"/>	<input checked="" type="checkbox"/>	<input checked="" type="checkbox"/>	<input checked="" type="checkbox"/>
	<input checked="" type="checkbox"/>	<input checked="" type="checkbox"/>	<input checked="" type="checkbox"/>	<input checked="" type="checkbox"/>	<input checked="" type="checkbox"/>	<input checked="" type="checkbox"/>
	<input checked="" type="checkbox"/>	<input checked="" type="checkbox"/>	<input checked="" type="checkbox"/>	<input checked="" type="checkbox"/>	<input checked="" type="checkbox"/>	<input checked="" type="checkbox"/>
	<input checked="" type="checkbox"/>	<input checked="" type="checkbox"/>	<input checked="" type="checkbox"/>	<input checked="" type="checkbox"/>	<input checked="" type="checkbox"/>	<input checked="" type="checkbox"/>
	<input checked="" type="checkbox"/>	<input checked="" type="checkbox"/>	<input checked="" type="checkbox"/>	<input checked="" type="checkbox"/>	<input checked="" type="checkbox"/>	<input checked="" type="checkbox"/>
	<input checked="" type="checkbox"/>	<input checked="" type="checkbox"/>	<input checked="" type="checkbox"/>	<input checked="" type="checkbox"/>	<input checked="" type="checkbox"/>	<input checked="" type="checkbox"/>
	<input checked="" type="checkbox"/>	<input checked="" type="checkbox"/>	<input checked="" type="checkbox"/>	<input checked="" type="checkbox"/>	<input checked="" type="checkbox"/>	<input checked="" type="checkbox"/>
	<input checked="" type="checkbox"/>	<input checked="" type="checkbox"/>	<input checked="" type="checkbox"/>	<input checked="" type="checkbox"/>	<input checked="" type="checkbox"/>	<input checked="" type="checkbox"/>
	<input checked="" type="checkbox"/>	<input checked="" type="checkbox"/>	<input checked="" type="checkbox"/>	<input checked="" type="checkbox"/>	<input checked="" type="checkbox"/>	<input checked="" type="checkbox"/>
	<input checked="" type="checkbox"/>	<input checked="" type="checkbox"/>	<input checked="" type="checkbox"/>	<input checked="" type="checkbox"/>	<input checked="" type="checkbox"/>	<input checked="" type="checkbox"/>
	<input checked="" type="checkbox"/>	<input checked="" type="checkbox"/>	<input checked="" type="checkbox"/>	<input checked="" type="checkbox"/>	<input checked="" type="checkbox"/>	<input checked="" type="checkbox"/>
	<input checked="" type="checkbox"/>	<input checked="" type="checkbox"/>	<input checked="" type="checkbox"/>	<input checked="" type="checkbox"/>	<input checked="" type="checkbox"/>	<input checked="" type="checkbox"/>
	<input checked="" type="checkbox"/>	<input checked="" type="checkbox"/>	<input checked="" type="checkbox"/>	<input checked="" type="checkbox"/>	<input checked="" type="checkbox"/>	<input checked="" type="checkbox"/>
	<input checked="" type="checkbox"/>	<input checked="" type="checkbox"/>	<input checked="" type="checkbox"/>	<input checked="" type="checkbox"/>	<input checked="" type="checkbox"/>	<input checked="" type="checkbox"/>
	<input checked="" type="checkbox"/>	<input checked="" type="checkbox"/>	<input checked="" type="checkbox"/>	<input checked="" type="checkbox"/>	<input checked="" type="checkbox"/>	<input checked="" type="checkbox"/>
	<input checked="" type="checkbox"/>	<input checked="" type="checkbox"/>	<input checked="" type="checkbox"/>	<input checked="" type="checkbox"/>	<input checked="" type="checkbox"/>	<input checked="" type="checkbox"/>
	<input checked="" type="checkbox"/>	<input checked="" type="checkbox"/>	<input checked="" type="checkbox"/>	<input checked="" type="checkbox"/>	<input checked="" type="checkbox"/>	<input checked="" type="checkbox"/>
	<input checked="" type="checkbox"/>	<input checked="" type="checkbox"/>	<input checked="" type="checkbox"/>	<input checked="" type="checkbox"/>	<input checked="" type="checkbox"/>	<input checked="" type="checkbox"/>
	<input checked="" type="checkbox"/>	<input checked="" type="checkbox"/>	<input checked="" type="checkbox"/>	<input checked="" type="checkbox"/>	<input checked="" type="checkbox"/>	<input checked="" type="checkbox"/>
	<input checked="" type="checkbox"/>	<input checked="" type="checkbox"/>	<input checked="" type="checkbox"/>	<input checked="" type="checkbox"/>	<input checked="" type="checkbox"/>	<input checked="" type="checkbox"/>
	<input checked="" type="checkbox"/>	<input checked="" type="checkbox"/>	<input checked="" type="checkbox"/>	<input checked="" type="checkbox"/>	<input checked="" type="checkbox"/>	<input checked="" type="checkbox"/>
	<input checked="" type="checkbox"/>	<input checked="" type="checkbox"/>	<input checked="" type="checkbox"/>	<input checked="" type="checkbox"/>	<input checked="" type="checkbox"/>	<input checked="" type="checkbox"/>
	<input checked="" type="checkbox"/>	<input checked="" type="checkbox"/>	<input checked="" type="checkbox"/>	<input checked="" type="checkbox"/>	<input checked="" type="checkbox"/>	<input checked="" type="checkbox"/>
	<input checked="" type="checkbox"/>	<input checked="" type="checkbox"/>	<input checked="" type="checkbox"/>	<input checked="" type="checkbox"/>	<input checked="" type="checkbox"/>	<input checked="" type="checkbox"/>
	<input checked="" type="checkbox"/>	<input checked="" type="checkbox"/>	<input checked="" type="checkbox"/>	<input checked="" type="checkbox"/>	<input checked="" type="checkbox"/>	<input checked="" type="checkbox"/>
	<input checked="" type="checkbox"/>	<input checked="" type="checkbox"/>	<input checked="" type="checkbox"/>	<input checked="" type="checkbox"/>	<input checked="" type="checkbox"/>	<input checked="" type="checkbox"/>
	<input checked="" type="checkbox"/>	<input checked="" type="checkbox"/>	<input checked="" type="checkbox"/>	<input checked="" type="checkbox"/>	<input checked="" type="checkbox"/>	<input checked="" type="checkbox"/>
	<input checked="" type="checkbox"/>	<input checked="" type="checkbox"/>	<input checked="" type="checkbox"/>	<input checked="" type="checkbox"/>	<input checked="" type="checkbox"/>	<input checked="" type="checkbox"/>
	<input checked="" type="checkbox"/>	<input checked="" type="checkbox"/>	<input checked="" type="checkbox"/>	<input checked="" type="checkbox"/>	<input checked="" type="checkbox"/>	<input checked="" type="checkbox"/>
	<input checked="" type="checkbox"/>	<input checked="" type="checkbox"/>	<input checked="" type="checkbox"/>	<input checked="" type="checkbox"/>	<input checked="" type="checkbox"/>	<input checked="" type="checkbox"/>
	<input checked="" type="checkbox"/>	<input checked="" type="checkbox"/>	<input checked="" type="checkbox"/>	<input checked="" type="checkbox"/>	<input checked="" type="checkbox"/>	<input checked="" type="checkbox"/>
	<input checked="" type="checkbox"/>	<input checked="" type="checkbox"/>	<input checked="" type="checkbox"/>	<input checked="" type="checkbox"/>	<input checked="" type="checkbox"/>	<input checked="" type="checkbox"/>
	<input checked="" type="checkbox"/>	<input checked="" type="checkbox"/>	<input checked="" type="checkbox"/>	<input checked="" type="checkbox"/>	<input checked="" type="checkbox"/>	<input checked="" type="checkbox"/>
	<input checked="" type="checkbox"/>	<input checked="" type="checkbox"/>	<input checked="" type="checkbox"/>	<input checked="" type="checkbox"/>	<input checked="" type="checkbox"/>	<input checked="" type="checkbox"/>
	<input checked="" type="checkbox"/>	<input checked="" type="checkbox"/>	<input checked="" type="checkbox"/>	<input checked="" type="checkbox"/>	<input checked="" type="checkbox"/>	<input checked="" type="checkbox"/>
	<input checked="" type="checkbox"/>	<input checked="" type="checkbox"/>	<input checked="" type="checkbox"/>	<input checked="" type="checkbox"/>	<input checked="" type="checkbox"/>	<input checked="" type="checkbox"/>
	<input checked="" type="checkbox"/>	<input checked="" type="checkbox"/>	<input checked="" type="checkbox"/>	<input checked="" type="checkbox"/>	<input checked="" type="checkbox"/>	<input checked="" type="checkbox"/>
	<input checked="" type="checkbox"/>	<input checked="" type="checkbox"/>	<input checked="" type="checkbox"/>	<input checked="" type="checkbox"/>	<input checked="" type="checkbox"/>	<input checked="" type="checkbox"/>
	<input checked="" type="checkbox"/>	<input checked="" type="checkbox"/>	<input checked="" type="checkbox"/>	<input checked="" type="checkbox"/>	<input checked="" type="checkbox"/>	<input checked="" type="checkbox"/>
	<input checked="" type="checkbox"/>	<input checked="" type="checkbox"/>	<input checked="" type="checkbox"/>	<input checked="" type="checkbox"/>	<input checked="" type="checkbox"/>	<input checked="" type="checkbox"/>
	<input checked="" type="checkbox"/>	<input checked="" type="checkbox"/>	<input checked="" type="checkbox"/>	<input checked="" type="checkbox"/>	<input checked="" type="checkbox"/>	<input checked="" type="checkbox"/>
	<input checked="" type="checkbox"/>	<input checked="" type="checkbox"/>	<input checked="" type="checkbox"/>	<input checked="" type="checkbox"/>	<input checked="" type="checkbox"/>	<input checked="" type="checkbox"/>
	<input checked="" type="checkbox"/>	<input checked="" type="checkbox"/>	<input checked="" type="checkbox"/>	<input checked="" type="checkbox"/>	<input checked="" type="checkbox"/>	<input checked="" type="checkbox"/>
	<input checked="" type="checkbox"/>	<input checked="" type="checkbox"/>	<input checked="" type="checkbox"/>	<input checked="" type="checkbox"/>	<input checked="" type="checkbox"/>	<input checked="" type="checkbox"/>
	<input checked="" type="checkbox"/>	<input checked="" type="checkbox"/>	<input checked="" type="checkbox"/>	<input checked="" type="checkbox"/>	<input checked="" type="checkbox"/>	<input checked="" type="checkbox"/>
	<input checked="" type="checkbox"/>	<input checked="" type="checkbox"/>	<input checked="" type="checkbox"/>	<input checked="" type="checkbox"/>	<input checked="" type="checkbox"/>	<input checked="" type="checkbox"/>
	<input checked="" type="checkbox"/>	<input checked="" type="checkbox"/>	<input checked="" type="checkbox"/>	<input checked="" type="checkbox"/>	<input checked="" type="checkbox"/>	<input checked="" type="checkbox"/>
	<input checked="" type="checkbox"/>	<input checked="" type="checkbox"/>	<input checked="" type="checkbox"/>	<input checked="" type="checkbox"/>	<input checked="" type="checkbox"/>	<input checked="" type="checkbox"/>
	<input checked="" type="checkbox"/>	<input checked="" type="checkbox"/>	<input checked="" type="checkbox"/>	<input checked="" type="checkbox"/>	<input checked="" type="checkbox"/>	<input checked="" type="checkbox"/>
	<input checked="" type="checkbox"/>	<input checked="" type="checkbox"/>	<input checked="" type="checkbox"/>	<input checked="" type="checkbox"/>	<input checked="" type="checkbox"/>	<input checked="" type="checkbox"/>
	<input checked="" type="checkbox"/>	<input checked="" type="checkbox"/>	<input checked="" type="checkbox"/>	<input checked="" type="checkbox"/>	<input checked="" type="checkbox"/>	<input checked="" type="checkbox"/>
	<input checked="" type="checkbox"/>	<input checked="" type="checkbox"/>	<input checked="" type="checkbox"/>	<input checked="" type="checkbox"/>	<input checked="" type="checkbox"/>	<input checked="" type="checkbox"/>
	<input checked="" type="checkbox"/>	<input checked="" type="checkbox"/>	<input checked="" type="checkbox"/>	<input checked="" type="checkbox"/>	<input checked="" type="checkbox"/>	<input checked="" type="checkbox"/>
	<input checked="" type="checkbox"/>	<input checked="" type="checkbox"/>	<input checked="" type="checkbox"/>	<input checked="" type="checkbox"/>	<input checked="" type="checkbox"/>	<input checked="" type="checkbox"/>
	<input checked="" type="checkbox"/>	<input checked="" type="checkbox"/>	<input checked="" type="checkbox"/>	<input checked="" type="checkbox"/>	<input checked="" type="checkbox"/>	<input checked="" type="checkbox"/>
	<input checked="" type="checkbox"/>	<input checked="" type="checkbox"/>	<input checked="" type="checkbox"/>	<input checked="" type="checkbox"/>	<input checked="" type="checkbox"/>	<input checked="" type="checkbox"/>
	<input checked="" type="checkbox"/>	<input checked="" type="checkbox"/>	<input checked="" type="checkbox"/>	<input checked="" type="checkbox"/>	<input checked="" type="checkbox"/>	<input checked="" type="checkbox"/>
	<input checked="" type="checkbox"/>	<input checked="" type="checkbox"/>	<input checked="" type="checkbox"/>	<input checked="" type="checkbox"/>	<input checked="" type="checkbox"/>	<input checked="" type="checkbox"/>
	<input checked="" type="checkbox"/>	<input checked="" type="checkbox"/>	<input checked="" type="checkbox"/>	<input checked="" type="checkbox"/>	<input checked="" type="checkbox"/>	<input checked="" type="checkbox"/>
	<input checked="" type="checkbox"/>	<input checked="" type="checkbox"/>	<input checked="" type="checkbox"/>	<input checked="" type="checkbox"/>	<input checked="" type="checkbox"/>	<input checked="" type="checkbox"/>
	<input checked="" type="checkbox"/>	<input checked="" type="checkbox"/>	<input checked="" type="checkbox"/>	<input checked="" type="checkbox"/>	<input checked="" type="checkbox"/>	<input checked="" type="checkbox"/>
	<input checked="" type="checkbox"/>	<input checked="" type="checkbox"/>	<input checked="" type="checkbox"/>	<input checked="" type="checkbox"/>	<input checked="" type="checkbox"/>	<input checked="" type="checkbox"/>
	<input checked="" type="checkbox"/>	<input checked="" type="checkbox"/>	<input checked="" type="checkbox"/>	<input checked="" type="checkbox"/>	<input checked="" type="checkbox"/>	<input checked="" type="checkbox"/>
	<input checked="" type="checkbox"/>	<input checked="" type="checkbox"/>	<input checked="" type="checkbox"/>	<input checked="" type="checkbox"/>	<input checked="" type="checkbox"/>	<input checked="" type="checkbox"/>
	<input checked="" type="checkbox"/>	<input checked="" type="checkbox"/>	<input checked="" type="checkbox"/>	<input checked="" type="checkbox"/>	<input checked="" type="checkbox"/>	<input checked="" type="checkbox"/>
	<input checked="" type="checkbox"/>	<input checked="" type="checkbox"/>	<input checked="" type="checkbox"/>	<input checked="" type="checkbox"/>	<input checked="" type="checkbox"/>	<input checked="" type="checkbox"/>
	<input checked="" type="checkbox"/>	<input checked="" type="checkbox"/>	<input checked="" type="checkbox"/>	<input checked="" type="checkbox"/>	<input checked="" type="checkbox"/>	<input checked="" type="checkbox"/>
	<input checked="" type="checkbox"/>	<input checked="" type="checkbox"/>	<input checked="" type="checkbox"/>	<input checked="" type="checkbox"/>	<input checked="" type="checkbox"/>	<input checked="" type="checkbox"/>
	<input checked="" type="checkbox"/>	<input checked="" type="checkbox"/>	<input checked="" type="checkbox"/>	<input checked="" type="checkbox"/>	<input checked="" type="checkbox"/>	<input checked="" type="checkbox"/>
	<input checked="" type="checkbox"/>	<input checked="" type="checkbox"/>	<input checked="" type="checkbox"/>	<input checked="" type="checkbox"/>	<input checked="" type="checkbox"/>	<input checked="" type="checkbox"/>
	<input checked="" type="checkbox"/>	<input checked="" type="checkbox"/>	<input checked="" type="checkbox"/>	<input checked="" type="checkbox"/>	<input checked="" type="checkbox"/>	<input checked="" type="checkbox"/>
	<input checked="" type="checkbox"/>	<input checked="" type="checkbox"/>	<input checked="" type="checkbox"/>	<input checked="" type="checkbox"/>	<input checked="" type="checkbox"/>	<input checked="" type="checkbox"/>
	<input checked="" type="checkbox"/>	<input checked="" type="checkbox"/>	<input checked="" type="checkbox"/>	<input checked="" type="checkbox"/>	<input checked="" type="checkbox"/>	<input checked="" type="checkbox"/>
	<input checked="" type="checkbox"/>	<input checked="" type="checkbox"/>	<input checked="" type="checkbox"/>	<input checked="" type="checkbox"/>	<input checked="" type="checkbox"/>	<input checked="" type="checkbox"/>
	<input checked="" type="checkbox"/>	<input checked="" type="checkbox"/>	<input checked="" type="checkbox"/>	<input checked="" type="checkbox"/>	<input checked="" type="checkbox"/>	<input checked="" type="checkbox"/>
	<input checked="" type="checkbox"/>	<input checked="" type="checkbox"/>	<input checked="" type="checkbox"/>	<input checked="" type="checkbox"/>	<input checked="" type="checkbox"/>	<input checked="" type="checkbox"/>
	<input checked="" type="checkbox"/>	<input checked="" type="checkbox"/>	<input checked="" type="checkbox"/>	<input checked="" type="checkbox"/>	<input checked="" type="checkbox"/>	<input checked="" type="checkbox"/>
	<input checked="" type="checkbox"/>	<input checked="" type="checkbox"/>	<input checked="" type="checkbox"/>	<input checked="" type="checkbox"/>	<input checked="" type="checkbox"/>	<input checked="" type="checkbox"/>
	<input checked="" type="checkbox"/>	<input checked="" type="checkbox"/>	<input checked="" type="checkbox"/>	<input checked="" type="checkbox"/>	<input checked="" type="checkbox"/>	<input checked="" type="checkbox"/>
	<input checked="" type="checkbox"/>	<input checked="" type="checkbox"/>	<input checked="" type="checkbox"/>	<input checked="" type="checkbox"/>	<input checked="" type="checkbox"/>	<input checked="" type="checkbox"/>
	<input checked="" type="checkbox"/>	<input checked="" type="checkbox"/>	<input checked="" type="checkbox"/>	<input checked="" type="checkbox"/>	<input checked="" type="checkbox"/>	<input checked="" type="checkbox"/>
	<input checked="" type="checkbox"/>	<input checked="" type="checkbox"/>	<input checked="" type="checkbox"/>	<input checked="" type="checkbox"/>	<input checked="" type="checkbox"/>	<input checked="" type="checkbox"/>
	<input checked="" type="checkbox"/>	<input checked="" type="checkbox"/>	<input checked="" type="checkbox"/>	<input checked="" type="checkbox"/>	<input checked="" type="checkbox"/>	<input checked="" type="checkbox"/>
	<input checked="" type="checkbox"/>	<input checked="" type="checkbox"/>	<input checked="" type="checkbox"/>	<input checked="" type="checkbox"/>	<input checked="" type="checkbox"/>	<input checked="" type="checkbox"/>
	<input checked="" type="checkbox"/>	<input checked="" type="checkbox"/>	<input checked="" type="checkbox"/>	<input checked="" type="checkbox"/>	<input checked="" type="checkbox"/>	<input checked="" type="checkbox"/>
	<input checked="" type="checkbox"/>	<input checked="" type="checkbox"/>	<input checked="" type="checkbox"/>	<input checked="" type="checkbox"/>	<input checked="" type="checkbox"/>	<input checked="" type="checkbox"/>
	<input checked="" type="checkbox"/>	<input checked="" type="checkbox"/>	<input checked="" type="checkbox"/>	<input checked="" type="checkbox"/>	<input checked="" type="checkbox"/>	<input checked="" type="checkbox"/>
	<input checked="" type="checkbox"/>	<input checked="" type="checkbox"/>	<input checked="" type="checkbox"/>	<input checked="" type="checkbox"/>	<input checked="" type="checkbox"/>	<input checked="" type="checkbox"/>
	<input checked="" type="checkbox"/>	<input checked="" type="checkbox"/>	<input checked="" type="checkbox"/>	<input checked="" type="checkbox"/>	<input checked="" type="checkbox"/>	<input checked="" type="checkbox"/>
	<input checked="" type="checkbox"/>	<input checked="" type="checkbox"/>	<input checked="" type="checkbox"/>	<input checked="" type="checkbox"/>	<input checked="" type="checkbox"/>	<input checked="" type="checkbox"/>
	<input checked="" type="checkbox"/>	<input checked="" type="checkbox"/>	<input checked="" type="checkbox"/>	<input checked="" type="checkbox"/>	<input checked="" type="checkbox"/>	<input checked="" type="checkbox"/>
	<input checked="" type="checkbox"/>	<input checked="" type="checkbox"/>	<input checked="" type="checkbox"/>			

WAIAU TOA/CLARENCE RIVER - GLEN ALTON BRIDGE

Permanent all-weather road access to the Glen Alton area from State Highway via Clarence Valley Road and the 130m long Glen Alton Bridge over the Waiau Toa/Clarence River was lost during the 16 November 2016 earthquake. The loss of the bridge and 600m of the road approaching the bridge on the northern side, cut-off the Glen Alton community of about 15 residents and leaseholders (11 different registered landowners) on the south side of the river. The earthquake also created changes to the river that have impacted access along the Clarence Valley Road, with flooding resulting in closure of a section of the road and a risk of the road being eroded at Priams Flat.

The loss of all-weather access has impacted multiple economic activities in the Glen Alton community, including but not limited to forestry, farming and community (employment, property etc.).

Option 1 would require 100% Council capital funding. Option 2 has external funding, with only 5% Council capital funding required.

OPTION 1

Access via Clarence Valley Road, and a permanent replacement bridge in the same location as the former Glen Alton Bridge. Additional works to maintain the Clarence Valley Road (including protection works).

- Must be 100% Council funded (currently unbudgeted)
- Replacement of single lane bridge constructed at location of previous Glen Alton bridge.
- On true left bank: substantial works required to rebuild section of the Clarence Valley Road that was lost.
- Approximately 750m of new road cut into Jacob Hill.
- On true right bank: bridge connects to Clarence Valley Road (existing).
- Heavy duty rock protection at the toe of Jacob Hill.
- 38,800 m³ of rock protection required.
- Property purchase required.

TOTAL PROJECT COST \$19,300,000

TOTAL CAPITAL COST FUNDED BY COUNCIL \$19,300,000

- **No NZTA funding**
- **Council would need to fund 100% of all project costs (total project estimated up to \$19.3 million)**

OPERATIONAL COST (PER ANNUM) \$202,000

- **Council would need to fund 100% of all Southern Access Route maintenance costs after 1 July 2020 (estimated at \$150,000 per annum)**



OPTION 2

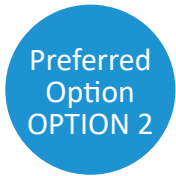

Access via Clarence Valley Road and a permanent bridge across the new channel (approximately 500m downstream of the former bridge) and then a ford across the normally dry bed of the former river channel. Additional works to maintain the Clarence Valley Road (including protection works).

KEY DETAILS:

- 5% Council capital funded (95% external NZTA funded)
- New single lane bridge across the new (post-earthquake) channel on the northern side of the valley, with rock protection required.
- New unsealed section of the Clarence Valley Road across island and flood plain of the Waiau Toa/Clarence River, and on the southern side of the valley to meet the existing road network.
- New 60m long engineered ford across over the former main channel (currently an overflow channel).
- Extensive new rock protection required.
- Property purchase required.

TOTAL PROJECT COST INCLUDING EXTERNAL FUNDING \$12,200,000

TOTAL CAPITAL COST FUNDED BY COUNCIL \$610,000

- **Council will need to fund 5% of all project costs (estimated at \$610,000), which includes all Southern Access Route temporary maintenance costs after 1 September 2020 through to project completion in 2022/23**

OPERATIONAL COST (PER ANNUM) \$142,000

- **Council will need to fund 49% of road/bridge maintenance costs following project completion in 2022/23, when the new roading assets become part of the Council's local road network subsidised by NZTA with a Financial Assistance Rate of 51%**

IMPLICATIONS:

This project is not required to meet the same level of resilience that existed pre-earthquake, rather options are assessed against the NZTA's One Network Road Classification thresholds for access/access low volume roads where a limited number of route outages per year can be tolerated.



Ngāti Kurī have a strong connection to the Waiau Toa stretching back 100's of years and many generations. The Waiau Toa connects Te Tai o Marokura (the sea) and ka tiritiri o te moana (the southern alps). Ngāti Kurī tell the story of the Waiau Toa being a male whose female counterpart is the Waiau Uwha, connected at their headwaters. In past times the Waiau Toa was used for many purposes including linking people to places, just as the Waiau Toa bridge will do.



New Community Pool Entrance

KAIKŌURA AQUATIC CENTRE

THE NEW COMMUNITY POOL FOR KAIKŌURA IS UNDERWAY

Kaikōura's only community pool closed in 2016 after it was damaged by the earthquake. The Kaikōura Community Charitable Trust is now leading a project to build a new indoor Aquatic Centre over the next 4 years.

The complex is being built in stages;

Stage 1 is the construction of the outdoor pool complex. A developed design plan has been finalised. This includes a 25 x 12m lap pool, a 6m x 10m multi-use learn to swim/hydrotherapy pool and a beach entry toddler pool as well as changing rooms, toilets, a small office and outdoor tiered seating. If all funding is completed it is hoped construction can start by August/September 2020.

The longer term Stage 2 project goal includes roofing the complex and adding ventilation systems.

SUCCESSFUL GRANTS AND FUNDRAISING EFFORTS

The Trust has secured \$3M to date which includes a \$1M contribution to its construction from the Council. The Council has also previously committed to support the annual operating costs up to a maximum of \$250,000 per year.

With a total project cost estimate of \$3.7M the remaining funding shortfall is budgeted to be met through fundraising, sponsorship and a \$500,000 Rātā Foundation community loan. This loan is conditional on a number of matters, including a guarantee of the loan from Council. The approved Rātā loan would be charged to the Trust at an interest rate of 5%.

The Rātā loan would be repaid using Council funding sourced from ratepayers. Council proposes replacing the Rātā loan with an increased grant which would be cheaper for ratepayers. This issue requires community consultation.



"Make it more enjoyable for residents and not just tourists, i.e. pool and more community events."
– Community satisfaction survey feedback 2019

OPTION 1

- Council will increase its grant to build the Aquatic Centre from \$1M to \$1.5M.
- The extra \$0.5M will replace the loan to the Trust from the Rātā Foundation – which, with an interest rate of 5% is more expensive than borrowing rates for Council itself (and will have legal costs to establish).
- As Council will be funding the repayment of the Rātā loan by the Trust, replacing this with a direct Council grant will be cheaper for ratepayers.
- In addition, the additional grant will be offset by reducing the annual operating cost contribution from a maximum of \$0.25M to a maximum of \$0.07M – and this significantly reduces the potential annual cost to ratepayers.

OPTION 2

- The Trust will accept the Rātā loan.
- Council is required to guarantee the Rātā loan.
- As Council will be funding the repayment of the Rātā loan by the Trust, the cost saving to Council and ratepayers in Option 1 will not occur.

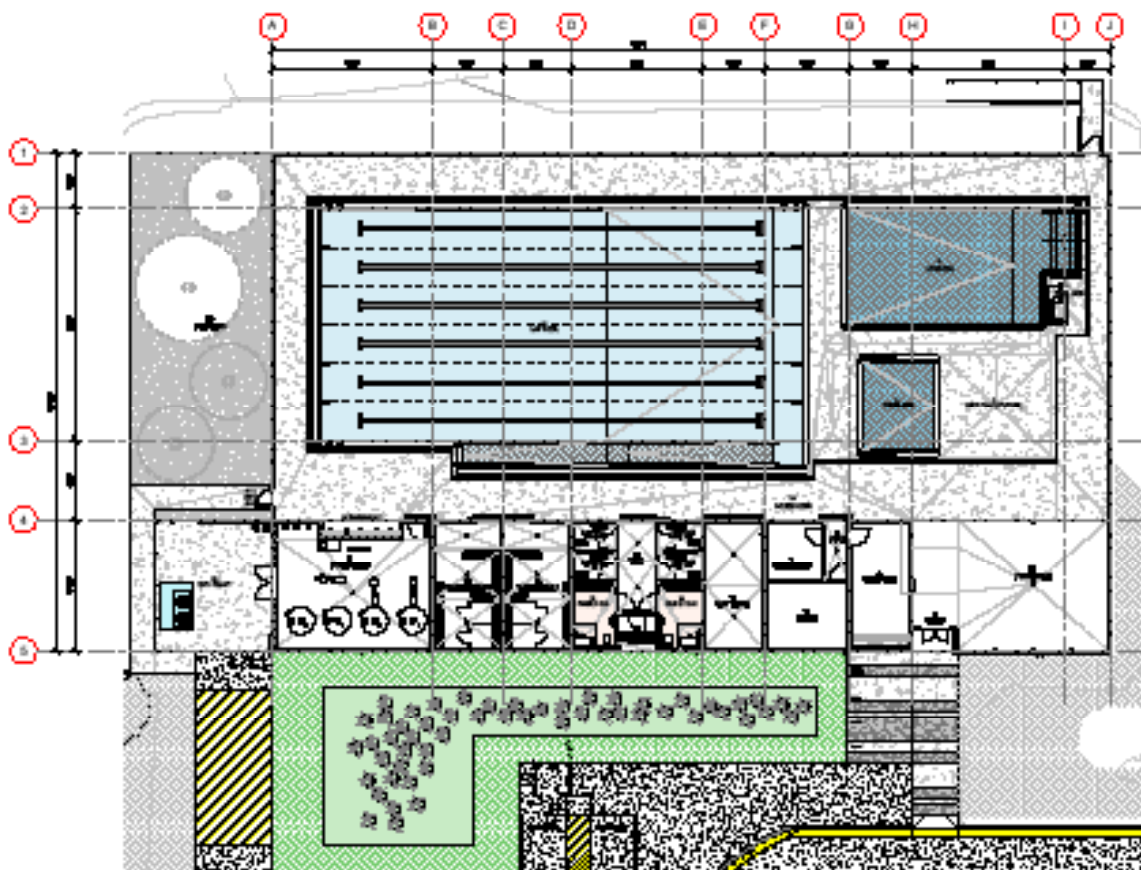

PROPOSED RATES

SMALLER RATES RISE THAN FORECAST FOR 2020/2021

This year's average proposed rates rise is 4.6%, well below the increase limit of 10% that was forecast for this year in our Three-Year Plan.

These figures are based on theoretical properties. They do include water rates for urban properties, but they do not include rural water rates where they apply to rural or semi-rural properties (because charges vary depending on water supply).

"I think the council staff and elected members have a very tough job ahead of them. But we need to ensure our future remains in our hands, and we must continue to stand alone."

- Community satisfaction survey feedback 2019

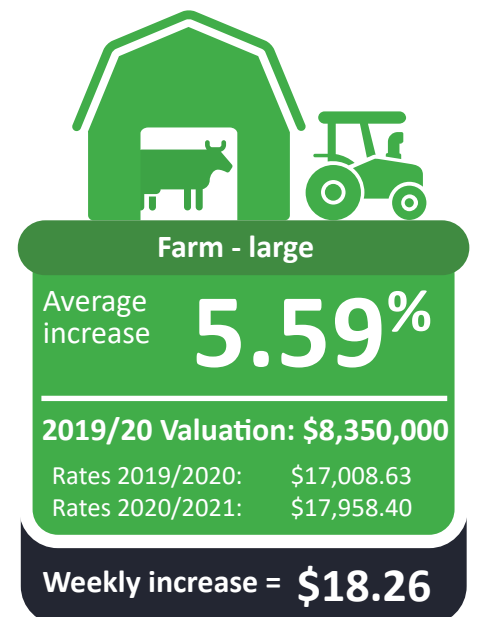
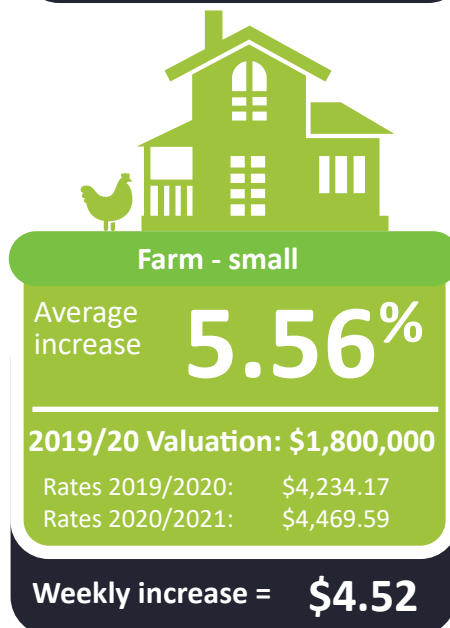
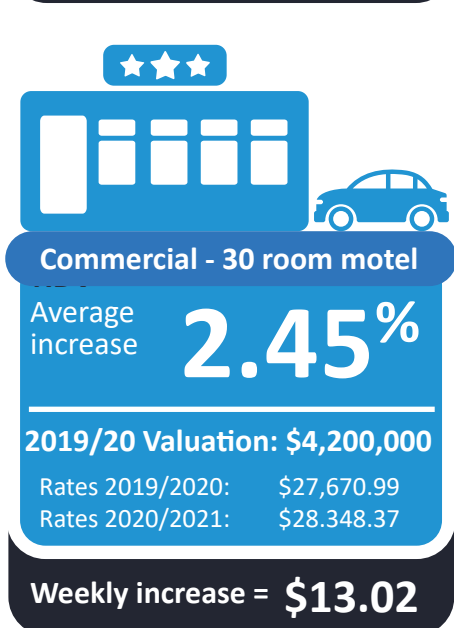
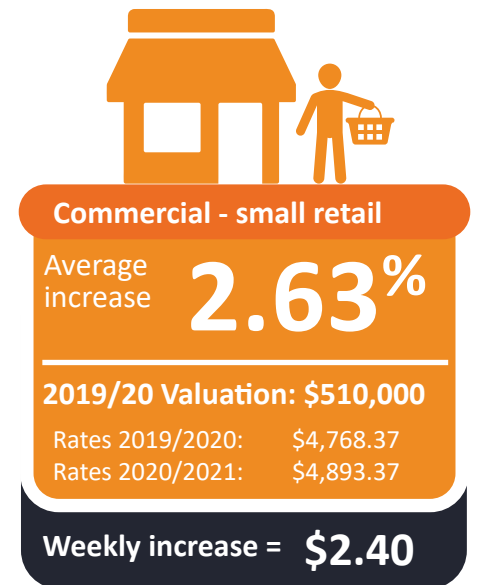
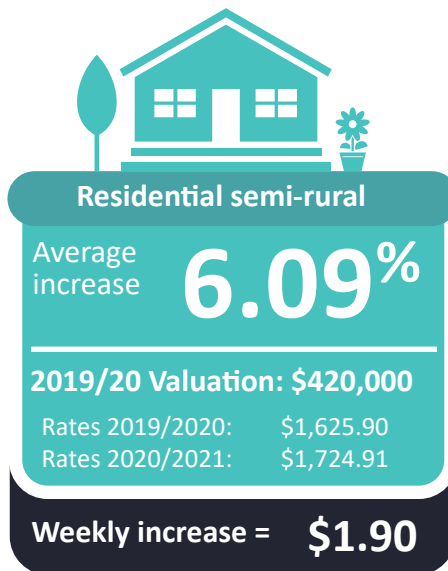
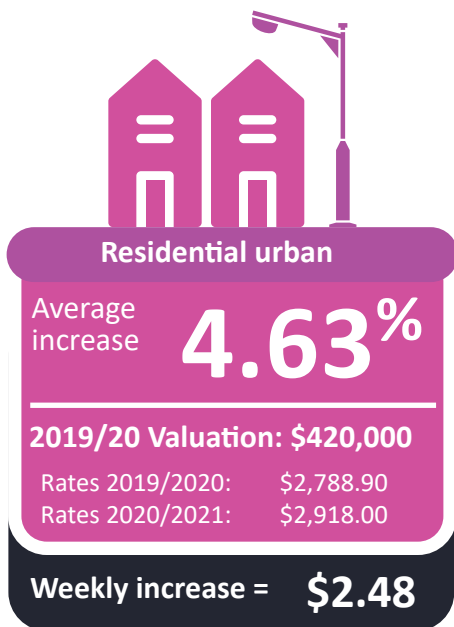

This year we're focusing on finishing the remaining projects in our earthquake rebuild programme, renewing our footpaths and converting our streetlights to LED. A new retail and hospitality precinct will be developed at Wakatu Quay thanks to \$10.88 million in funding from the Provincial Growth Fund, and the Scout Hall will have a major refurbish with \$138k from NZ Lotteries funding.

We are very mindful of the impact Covid-19 is having on our local economy and our community. Rates were forecast to increase by another 10% this year as we continue our recovery from the earthquake. Instead we've kept the increase below 5% by reducing our costs further, including trimming operating expenses (particularly in roading and recycling), and optimising use of short-term loans. With loan interest rates at record lows, it makes sense to borrow through the recession period and to continue to invest in our community.

This has been achieved in a particularly challenging environment. The Covid-19 pandemic has affected Council revenues as well, with consent revenue, airport and harbour fees, and lease revenues all forecast to be down on last year. Add to this the impact of the November 2016 earthquake, which has increased maintenance and operating costs. A further challenge is that our forestry investment, the Marlborough Regional Forest joint venture with the Marlborough District Council, will enter a period of no logging as the remaining trees are not yet mature, and so – instead of receiving a distribution from forestry – the Council will be paying into the joint venture to invest in planting and weed and pest control.

Despite these challenges, we have secured very low loan interest rates, we have ongoing external funding for some very exciting projects, and our water and wastewater infrastructure will be in very good condition thanks to the rebuild.

PLANNED SPEND PER \$100 OF RATES 2020/2021

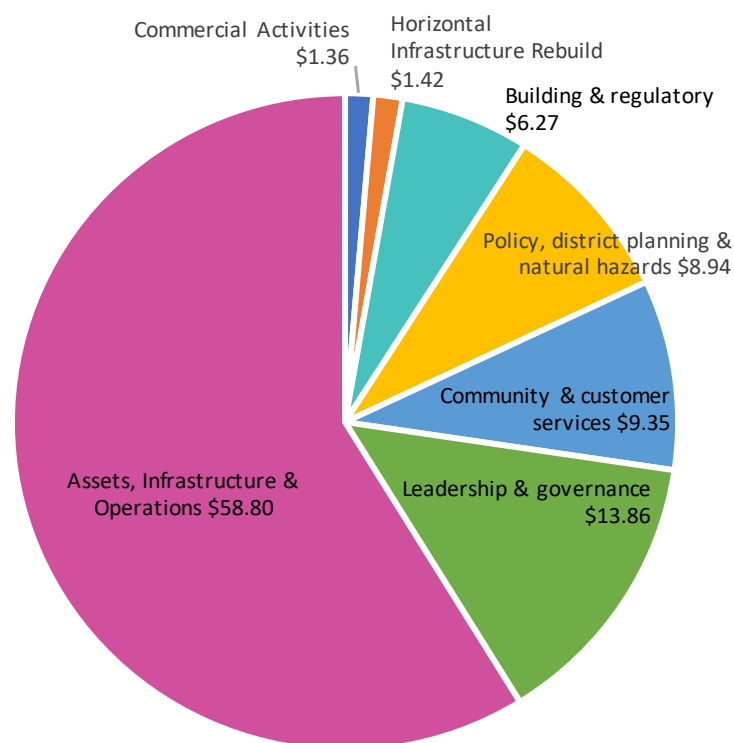

"Keep doing what you're doing."

- Community satisfaction survey feedback 2019



Summer sunshine on Wakatu Quay

KEY PROJECT MANAGEMENT

PROVINCIAL GROWTH FUND WAKATU QUAY/ SOUTH BAY BUSINESS CASE

Funding from the Provincial Growth Fund (PGF) of up to \$10.88 million will enable a transformational development to take shape at Wakatu Quay (the area encompassing the North Wharf and the former Pacifica Fisheries buildings). A feasibility study into future marina development at South Bay has also been made possible by the PGF grant.

Dependent on the outcome of the feasibility study, this could signal another significant multimillion-dollar project in the medium-to-long term. That future project would be a matter for the community, and potential business partners, to engage with as the Council develops the Long-Term Plan 2021-2032.

WHAT NEXT?

A governance group has been formed. The group will oversee the development at Wakatu Quay and the feasibility study at South Bay. A tender for the demolition of the existing properties has been advertised.



Sunset from Wakatu Quay

REBUILD UPDATE

Put into operation after the magnitude 7.8 earthquake in November 2016, the horizontal infrastructure rebuild is a programme of work with a total cost of approximately \$52.4 million. Thanks to funding from the government and insurance settlements, the total cost to the ratepayer is just \$2.8 million. All of the programme is due to be completed in the second half of 2020, with the exception of the Clarence Valley Access due to be completed in 2022-2023.

Covid-19 caused a small delay to the programme however projects continue to be managed within budget.

- A new pressure sewer main has been installed along Beach Road.
- A new aeration lagoon was commissioned at the wastewater treatment plant.
- 6 bridges have been replaced with some gaining an additional lane.
- 14 bridges have had minor structural repairs.

Works yet to be completed include the Fords and Peninsula Reservoirs, repairs to the Lyell Creek Pump Station, Mackles Bore and 3-Waters reticulation and manhole repairs.

*“Look after the local first, tourists will always come”
– Community satisfaction survey feedback 2019*

NATURAL HAZARDS CHAPTER, DISTRICT PLAN

The current District Plan has been operative since 2008 and is due for review. In November 2018 Council confirmed the District Plan will be reviewed as a series of plan changes (a ‘rolling review’) rather than one change.

The Natural Hazards chapter of the plan identifies where development is or isn’t appropriate (in terms of natural hazards) and what we should consider when developing areas subject to this risk.

Council now has updated information on natural hazards, including flooding, liquefaction, active faults and debris inundation. This information is the starting point for drafting new rules within the Natural Hazards chapter of the District Plan.

Landowners with property and homes that may be affected by natural hazards may be subject to new regulations. Within the District, due to its nature, many properties are potentially affected.

Public notification of the new rules will occur in the second half of 2020, the community will be invited to have their say and make submissions to Council. The District Plan Natural Hazards review is intended to be completed in the 2021/2022 financial year.

Council is consulting with Te Rūnanga O Kaikōura and working in partnership on many projects, including the Natural Hazards chapter of the District Plan.



Masefield Bridge repairs

HAVE YOUR SAY ON THE ANNUAL PLAN 2020/2021

COME AND TALK TO US

TARGET COMMUNITIES	DATE	TIME	LOCATION
Clarence / Kēkerengū	Thursday 9th July	5pm - 7pm	Kēkerengū Store
Inland Road / Oaro / Goose Bay	Tuesday 14th July	6pm - 8pm	Council Chambers
Everyone	Wednesday 22nd July	5pm - 7pm	Memorial Hall
Te Rūnanga o Kaikōura	Monday 27th July	5pm - 7pm	Takahanga Marae

WHERE DO I FIND OUT MORE?

- Attend a community discussion (see table above) and/or
- read the full draft Annual Plan via www.Kaikoura.govt.nz or pick up a copy from the Library or Council offices.
- keep an eye out for information in the newspaper, our Facebook page, through the website, noticeboards and on the radio.

HOW DO I HAVE MY SAY?

Have your say at www.Kaikoura.govt.nz or fill out a paper form and send it to us/drop it off.

Send it to: Kaikōura District Council, PO Box 6, 96 West End, Kaikōura or kdc@Kaikoura.govt.nz

Remember to let us know if you wish to speak at the hearings on August 10th and 11th.

Submissions must arrive at Council no later than 4pm Friday 31 July..

THEN WHAT?

Council will hear from anyone who wishes to speak at hearings.

Council deliberates on all feedback and decides what changes to make.

The Annual Plan will be adopted on 19th August 2020.

FILL OUT THE SUBMISSIONS FORM ON THE BACK OF THIS DOCUMENT

We want to hear your thoughts so please make a submission on this draft Annual Plan.

*He aha te mea nui o te ao?
He tāngata, he tāngata, he tāngata*

*What is the most important thing in the world?
It's the people, it's the people, it's the people.*



Wakatu Quay and Old Aquarium

SUBMISSIONS FORM

Name:

Address:

Email address:

Do you want to speak to Council at the hearings? Yes / No.

If yes, please provide a contact phone number:

Privacy Act Information - It is a requirement of the legislation for submissions to be made available to the public.

Your contact details are collected to arrange a hearing date and time for you to speak (if you choose to) and so the Council can write and inform you of the decision(s) on your submission(s).

Your name and address will be publicly available. If you would like your address and phone details (including email address) kept confidential you need to inform us when you send in your submission. You have the right to correct any errors in personal details contained in your submission. If you do not supply your name and address the Council will formally receive your submission, but will not be able to inform you of the outcome.

Rubbish and Recycling
see page 7

Option 1
 Option 2
 Option 3
 Option 4 - preferred option

Tell us why

Waiau Toa/Clarence River - Glen Alton Bridge
see page 10

Option 1
 Option 2 - preferred option

Tell us why

Kaikōura Aquatic Centre
see page 12

Option 1 - preferred option
 Option 2

Tell us why

